

Compact, rugged lathe for on-site re-turning of small shafts or journals

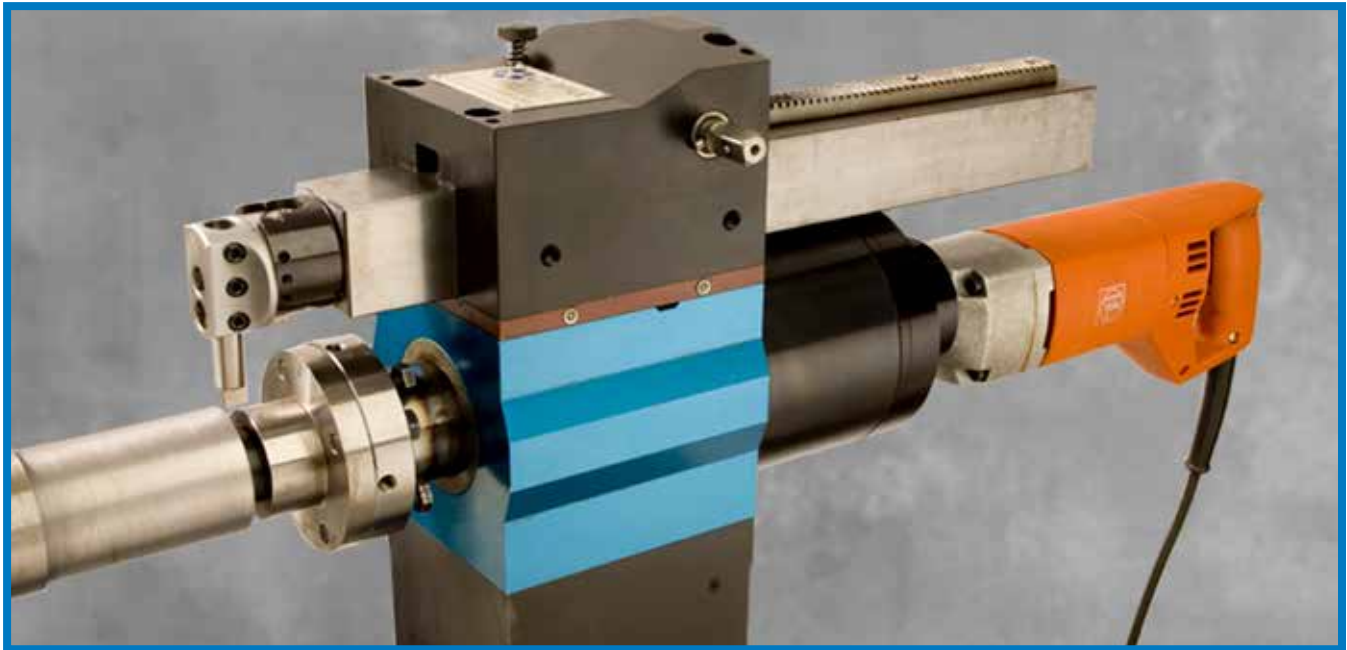

A compact, rugged portable lathe for on-site re-turning of small shafts or journals, the PL2000 Portable Lathe mounts on the end of the shaft.

Compact, powerful, precise.

- The 0.6 Hp (0.45 kW) electric motor and 5.5:1 gear reduction provides plenty of torque. A 1.22 Hp (0.91 kW) pneumatic motor is also available.
- Tool reach up to 12.5 inches (317.5 mm) from end of shaft.
- Criterion style tool head provides accurate depth adjustments in 0.001 inch (0.0254 mm) increments.
- Turns shafts from 1.5 - 9.0 inches (38.1 - 228.6 mm) in diameter. This

compact machine is able to work within a 14 inch (355.6 mm) diameter swing clearance at the end of the shaft.

- Automatic axial feed is infinitely variable from 0 - 0.35 inches/rev. (0 - 8.89 mm/rev.)
- Adjustable tool head and round tool bits allow quick tool positioning for accurate turning.

Quick and easy setup

- Mounts on the end of the shaft. Simply remove the gear or bearing to expose the end of the shaft.
- The PL2000 can be set up by an experienced operator in less than an hour.

Drill and tap four mounting holes on the end of the shaft to attach the mounting flange. (Shafts less than 3.75 inches (95.3 mm) in diameter only need one hole drilled and tapped for the single bolt mounting adapter.) The body of the machine is attached, centered, and aligned in a few minutes.

SPECIFICATIONS

	US	Metric
Machine Performance Ranges		
Turning Reach	12.5 inches	317.5 mm
Shaft dia. maximum		
without optional spacer/counterweight assembly	5.0 inches	127.0 mm
with the optional spacer/counterweight assembly	9.0 inches	228.6 mm
Shaft dia. minimum		
without optional spacer/counterweight assembly	1.5 inches	38.1 mm
Shaft dia. minimum	5.0 inches 127.0 mm	
with the optional spacer/counterweight assembly		
Feed rate, automatic (infinitely variable)	0 - 0.035 inches/rev.	0 - 0.89 mm/rev
Cutter modified	1/2 inch (12.7 mm) HSS round lathe tool bit	
Power Options		
Power, electric		
120V, 50/60 Hz or 230V, 50/60Hz	0.66 Hp	0.49 kW
Torque: 40 ft-lbs (53.7 N•m) at 78 rpm bar speed. Bar speed: 52 - 104 rpm max.		
Motor Speed: 110V: 0-109 rpm, 230V: 0-93 rpm. Variable speed control with continuous variable.		
Power, pneumatic	1.22 Hp	0.91 kW
(non-reversing, Hp rated at 200 rpm). Torque: 95 ft-lbs (127.6 N•m) at 55 rpm bar speed. Bar speed: 0 - 96 rpm max.		
Motor speed: 375 rpm no load, 200 rpm full load. Infinitely variable speed control with needle valve.		
Air flow required: 90 psi @ 30 ft ³ /min (620 kPa @ 0.85 m ³ /min).		
Measures		
Overall length, electric		
bar fully retracted	27.0 inches	685.8 mm
bar fully extended	39.0 inches	990.6 mm
Overall length, pneumatic		
bar fully retracted	32.0 inches	812.8 mm
bar fully extended	44.5 inches	1130.3 mm
Overall height	13.75 inches	349.3 mm
without optional spacer/counterweight assembly		
with optional spacer/counterweight assembly	17.75 inches	450.9 mm
Operating weight, electric motor		
without spacers or counterweights	99 lbs	44.9 kg
with spacers and counterweights	116 lbs	52.6 kg
Operating weight, pneumatic motor		
without spacers or counterweights	94 lbs	42.6 kg
with spacers and counterweights	111 lbs	52.3 kg
Shipping weight	190 lbs	86.2 kg
Shipping dimensions L x W x H	26 x 19 x 15 inches	660.4 x 482.6 x 381.0 mm

OPERATIONAL DIMENSIONS

Dimensions in Inch (mm)

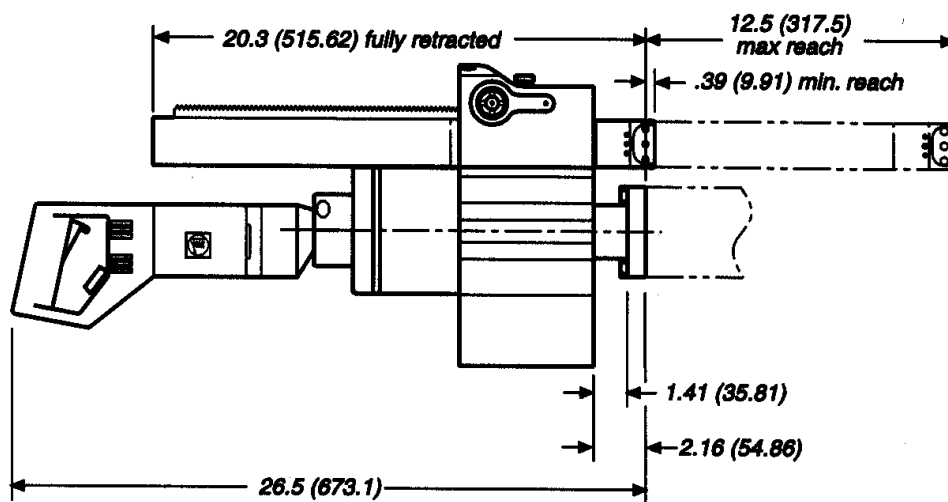

Min. swing clearance
7.0 (177.8) radius

Min. swing clearance
9.0 (228.6) radius with
2 (50.8) spacer

Mounting flange
3.75 (95.25) dia
4 x .40 on 3.03 BC
evenly spaced

PL2000 with Electric Motor

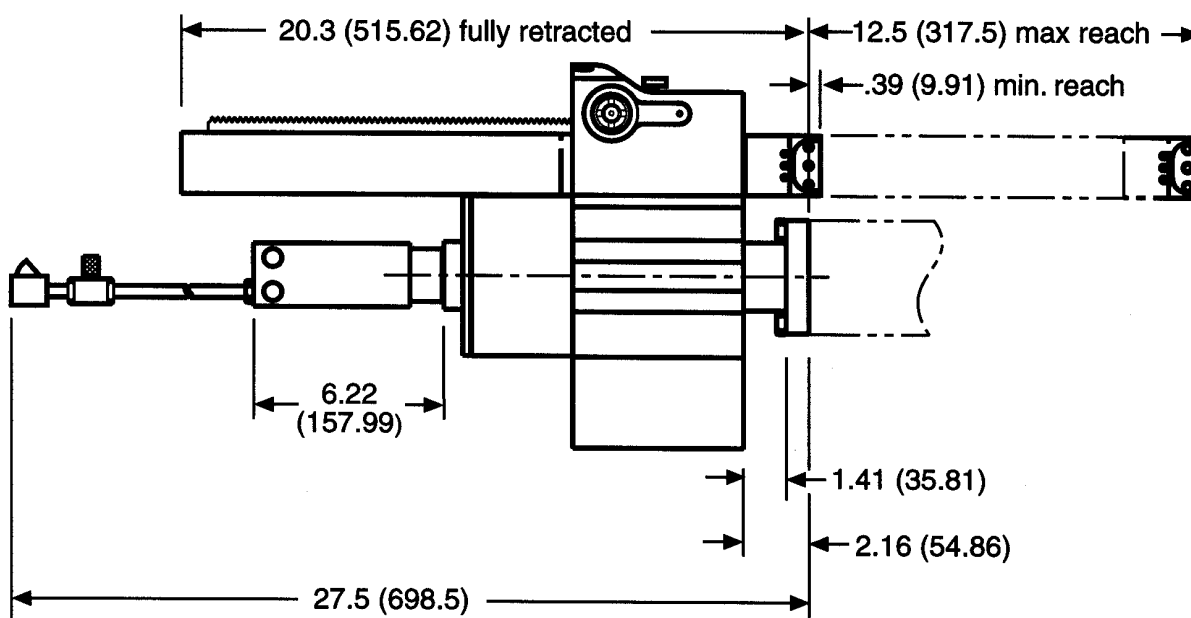

PL2000 with Pneumatic Motor

TOOL CONFIGURATIONS

Select your PL2000 in 5 easy steps.

- 1 Select a Machine Configuration
- 2 Select a Bolt Adapter
- 3 Select a Dial Indicator Assembly
- 4 Select a Spacer Assembly
- 5 Select a Tooling Pack

To configure the lathe you require, select the option you need in each step, then contact your CLIMAX representative.

1 Machine Configuration

PL2000 Portable Lathe, Electric 120 V, 60 Hz **31591**
 Standard PL2000 complete with 0.6 Hp (0.45 kW) electric motor, instruction manual, and tool kit. Shipped in wooden crate. Net weight 99 lb (44.9 kg).

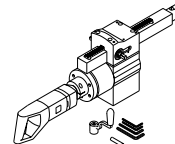

PL2000 Portable Lathe, Electric 230 V, 50 Hz **31593**
 As above, with 230 V, 50 Hz Motor.

PL2000 Portable Lathe, Pneumatic **31584**
 Standard PL2000 complete with 1.22 hp (.91 kW) pneumatic motor, instruction manual, tool kit and pneumatic conditioning unit. Shipped in wooden crate. Net weight 94 lb (42.7 kg).

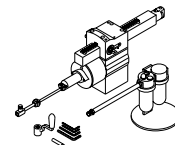

PL2000 Portable Lathe, Pneumatic, CE Compliant **31584CE**
 As above with CE approved pneumatic connection package with emergency air shutoff valve assembly.

2 Bolt Adapter

Single bolt mount adapter **30572**
 Allows attachment of the PL2000 to the end of the shaft with one bolt.
 Recommended for shafts under 3.75 inches (95.3 mm) in diameter.

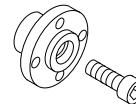

3 Dial Indicator Assembly

Dial Indicator Assembly **30407**
 Attaches to tool head for accurately aligning the machine.

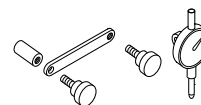

4 Spacer Assembly

Spacer assembly **31590**
 Spacer and counterweight assembly.
 Allows the PL2000 to turn 5.0 - 9.0 inches (127.0 - 228.6 mm) diameter shafts.
 Includes all mounting hardware.

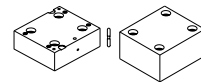

5 Tooling Pack

Tooling Pack (not shown) **37810**
 One ½ inch x 3.0 inch (12.7 mm x 76.2 mm) grooving/plunging tool bit, and one HSS ½ inch x 3.0 inch (12.7 mm x 76.2 mm) finishing tool bit in storage case.

